



## Facts

- Studentenwerk Leipzig runs 43 student halls of residence in 15 housing complexes with more than 5,200 rooms in shared flats or single apartments.
- For impaired students or students with child, special accommodation is available.
- More than 40 students, of whom most live in student halls of residence themselves, act as spokespersons or tutors for international students. In doing so, tenants can actively participate in their halls social environment and problems that arise can be solved quickly.

## Important Information

### When to apply?

You can apply immediately after receiving admission to your desired study program. With certificate of enrolment you can apply at any time.

### How to apply and where to find more information?

Simply online at [www.studentenwerk-leipzig.de/en/housing](http://www.studentenwerk-leipzig.de/en/housing)

## Contact

### Student Housing

Goethestraße 6, 04109 Leipzig  
Straße des 18. Oktober 23, 04103 Leipzig



### Office Hours

Tuesday 1.00 - 5.00 p.m.  
Thursday 9.00 - 11.00 a.m. and 1.00 - 3.00 p.m.  
Friday 9.00 - 11.00 a.m.

Phone +49 341 9659880  
[wohnen@studentenwerk-leipzig.de](mailto:wohnen@studentenwerk-leipzig.de)

### Postal Address

Studentenwerk Leipzig  
Postfach 100928  
04009 Leipzig

 Studentenwerk Leipzig  
 studentenwerkleipzig

[www.studentenwerk-leipzig.de/en/housing](http://www.studentenwerk-leipzig.de/en/housing)

# STUDENT HOUSING



### Imprint

Editor: Studentenwerk Leipzig, June 2019  
Photos: Swen Reichhold; Studentenwerk Leipzig

## We offer

- Apartments and single rooms in shared flats with two to six students
- All student halls of residence are situated close to campus or can be very easily reached by tram (inexpensive travel with our semester ticket)
- All-inclusive rents – all utilities are included (water, heating, electricity, minor repairs etc.). There are no additional charges!
- Furnished rooms: bed, table, chair, drawer, shelf
- A limited number of unfurnished rooms are available in student hall of residence Mainzer Straße
- Internet (300 GB / month)
- Approx. 30 TV channels
- Fitness rooms, party rooms, kitchens and other common rooms – Some halls even have a student club!
- Laundry rooms (washing / drying for a small fee) and bicycle storage rooms
- Our student halls of residence have been energetically renovated. In addition, we also only use electricity from renewable resources
- The deposit amounts to 300 EUR

## Floor Plan Examples

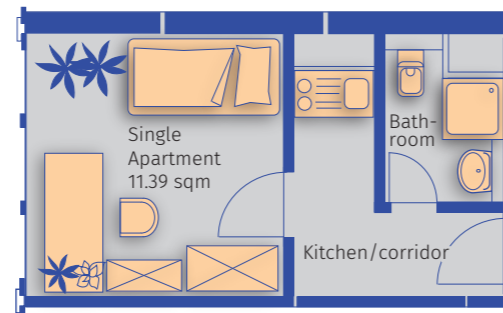
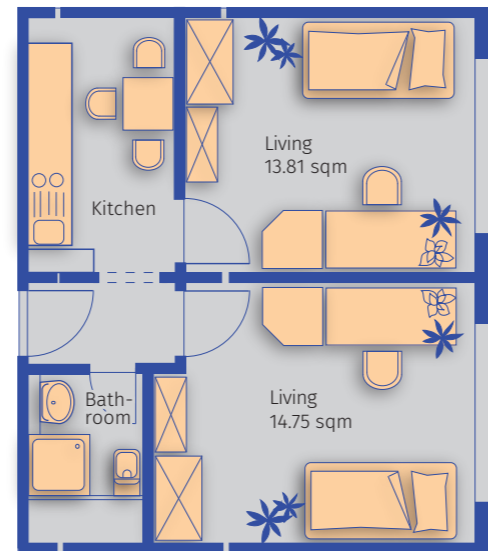

## Our Student Halls of Residence

Student Hall of Residence	District	Number of rooms	Rent* in EUR	
			Room in shared flat	Apartment
Str. des 18. Oktober 23-33	Zentrum-Südost	1.097	180 - 290	250 - 300
Tarostr. 12-18	Zentrum-Südost	673	180 - 290	250 - 320
Str. des 18. Oktober 17	Zentrum-Südost	82	320 - 360	365 - 425
Philipp-Rosenthal-Str. 29-33	Zentrum-Südost	429	210 - 230	250 - 270
Nürnbergger Str. 42-48, Brüderstr. 26	Zentrum-Südost	296	220 - 290	290 - 350
Arno-Nitzsche-Str. 40-44	Marienbrunn	487	170 - 240	240 - 300
Johannes-R.-Becher-Str. 3-11	Lößnig	902	170 - 230	240 - 290
Titaniaweg 7	Grünau-Nord	178	180 - 210	290
Mannheimer Str. 5-7	Grünau-Mitte	310	170 - 230	240
Gärtnerstr. 181	Grünau-Ost	203	190 - 210	220 - 270
Bornaische Str. 138, 138a, 138b	Dölitz-Dösen	36	220 - 270	290
Mainzer Str. 2	Zentrum-West	226	220 - 240	260 - 300
Mainzer Str. 2a	Zentrum-West	198	205 - 240	245 - 285
Talstr. 12a	Zentrum-Südost	64	290 - 310	365 - 405
Seeburgstr. 47	Zentrum-Südost	36	-	355 - 375
Gutenbergplatz 4	Zentrum-Südost	57	-	365 - 425

\* including utilities; without TV licence fee (Rundfunkbeitrag); all information subject to change; published June 2019

